

SUBDIVISION AND PLAT OF SURVEY PREPARED FOR: ELI E. YODER (H.M. AND S.R. MILLER SUBDIVISION)

DEED OF RECORD: H.M. AND S.R. MILLER VOLUME 619, PAGE 727

SITUATED IN THE TOWNSHIP OF TROY, COUNTY OF GEauga AND STATE OF OHIO AND KNOWN AS BEING PART OF SECTION NO. 2 WITHIN SAID TOWNSHIP.

PATCH ROAD 60'

MUMFORD ROAD 60'

ROAD 60'

25.2683 GROSS ACRE PARCEL

DEED OF RECORD: H.M. AND S.R. MILLER VOL. 619, PG. 727

20.0030 GROSS ACRE PARCEL

DEED OF RECORD: H.M. AND S.R. MILLER VOL. 619, PG. 727

1.4400 GROSS ACRE PARCEL

DEED OF RECORD: H.M. AND S.R. MILLER VOL. 619, PG. 727

- *ENCROACHMENTS*
 ADJACENT LAND OWNER: R. AND P. DOBAY
 1.) WIRE FENCE IS 28.5+ FEET WEST OF BOUNDARY LINE.
 2.) BARN ADDITION (NO FOUNDATION) IS WEST OF BOUNDARY LINE.
 3.) WIRE FENCE IS 17.0+ FEET NORTH OF ROAD MARGIN.
 4.) WIRE FENCE IS 12.0+ FEET SOUTH OF BOUNDARY LINE.

1" IRON PIN IN MONUMENT BOX FD. AND USED ANGLE POINT STA. - 120+64.5 (COUNTY)

1" IRON PIN IN MONUMENT BOX FD. AND USED ANGLE POINT (calc.) STA. - 113+86.7 (COUNTY)

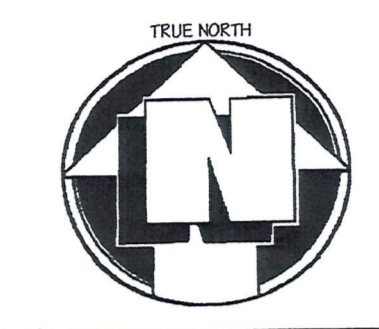

GRAPHIC SCALE: 1" = 100 FEET

- DENOTES 5/8" (DIAMETER) x 30" (LONG) IRON PIN WITH YELLOW PLASTIC CAP BEARING "KOSIE P.S. 8167" SET
- DENOTES BARBED WIRE FENCE FOUND
- - - DENOTES RIGHT-OF-WAY (R/W) CENTERLINE (C.L.)

BASIS OF RESEARCH AND RECORDS
 ALL COUNTY OWNERSHIP RESEARCH DATA AND PREVIOUS SURVEY RECORDS WERE OBTAINED FROM THE COUNTY RECORDER'S OFFICE AND THE COUNTY MAP ROOM.
 ALL COUNTY CENTERLINE AND RIGHT-OF-WAY DATA WAS OBTAINED FROM THE GAUGA COUNTY ENGINEER'S OFFICE.
 ALL STATE CENTERLINE AND RIGHT-OF-WAY DATA WAS OBTAINED FROM THE OHIO DEPARTMENT OF TRANSPORTATION (O.D.O.T.) RECORDS.

SURVEY PLAT & LEGAL DESCRIPTION APPROVED PER R.C. 315.251
 R.S. S.H.104
 OFFICE OF THE GAUGA COUNTY ENGINEER

MONUMENTS WERE FOUND OR SET AS INDICATED HEREON. DISTANCES ARE IN U.S. FEET WITH DECIMAL PARTS. BEARINGS ARE TO TRUE NORTH USING NAD83 (NGVD 29), APRIL 2004.

I HEREBY CERTIFY THAT I HAVE SURVEYED THESE PREMISES AND PREPARED THIS PLAT OF SURVEY IN ACCORDANCE WITH THE PROVISIONS OF CHAPTER 4733-37 OF THE OHIO REVISED CODE.

PLAT OF SURVEY PREPARED BY:
Delmar B. Kosie & Associates
 Registered Land Surveyors
 202 South Street
 Chardon, Ohio 44024-1321
 (440) 286-2131
 FAX: (440) 285-4579
 http://home.alltel.net/dbkads/home.htm

OUPS
 Ohio Utility Protection Service
 6740 Belmont Avenue Youngstown, OH 44505
 1-800-343-2764



Robert L. Kosie
ROBERT L. KOSIE, P.S.
 REGISTERED PROFESSIONAL LAND SURVEYOR
 REGISTRATION NO. 8167



DBK PLAT NO. 578 2004

TR0-00091

TR0 00091

Miller-Yoder

Picked up 5-6-04

Delmar B. Kosie & Associates



Registered Land Surveyors
202 South Street
Chardon, Ohio 44024-1321
(440) 286-2131
Fax: (440) 285-4579

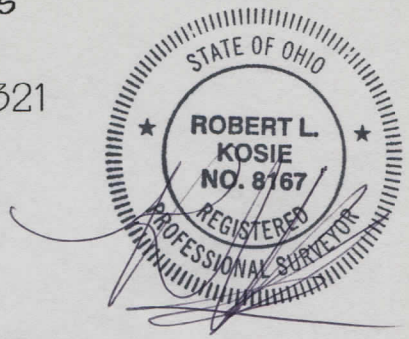

32-074314

Vol. 1731- Pg. 1847

SURVEY PLAT & LEGAL DESCRIPTION
APPROVED PER R.C. 315.251

5/4/04
R.S.

OFFICE OF THE
GEAUGA COUNTY ENGINEER

<http://home.alltel.net/dbkadsl/home.htm>

1.4400 GROSS ACRE PARCEL

DEED OF RECORD: H.M. AND S.R. MILLER VOLUME 619, PAGE 727

Date: APRIL 30TH, 2004

SITUATED IN THE TOWNSHIP OF TROY, COUNTY OF GEAUGA AND STATE OF OHIO AND KNOWN AS BEING PART OF ORIGINAL SECTION NO. 2 WITHIN SAID TOWNSHIP AND BOUNDED AND DESCRIBED AS FOLLOWS:

BEGINNING AT A 1" IRON PIN IN A MONUMENT BOX FOUND AT AN ANGLE POINT AT THE INTERSECTION OF PATCH ROAD (60 FEET WIDE) AND MUMFORD ROAD (60 FEET WIDE). SAID POINT BEING KNOWN AS CENTERLINE STATION 113+86.70 OF THE GEAUGA COUNTY ENGINEER'S RECORDS.

THENCE S03°05'50"E ALONG THE CENTERLINE OF MUMFORD ROAD A DISTANCE OF 725.70 FEET TO AN ANGLE POINT THEREIN. SAID POINT BEING KNOWN AS CENTERLINE STATION 106+61.00 OF THE GEAUGA COUNTY ENGINEER'S RECORDS.

THENCE S00°32'58"E CONTINUING ALONG SAID CENTERLINE A DISTANCE OF 251.16 FEET TO A POINT. SAID POINT BEING A SOUTHEASTERLY CORNER OF A PARCEL OF LAND CONVEYED TO S.A. AND A. MILLER AS RECORDED IN VOL. 597, PG. 227 OF GEAUGA COUNTY RECORDS AND DEEDS. SAID POINT ALSO BEING THE NORTHEASTERLY CORNER OF THE PARCEL HEREIN DESCRIBED AND **THE PRINCIPAL PLACE OF BEGINNING OF THIS SURVEY.**

THENCE S88°58'05"W ALONG A SOUTHERLY LINE OF SAID MILLER'S LAND AND PASSING THROUGH A 5/8" (DIAMETER) x 30" (LONG) IRON PIN WITH YELLOW PLASTIC CAP BEARING "KOSIE P.S. 8167" SET AT 30.00 FEET A TOTAL DISTANCE OF 369.00 FEET TO A 5/8" (DIAMETER) x 30" (LONG) IRON PIN WITH YELLOW PLASTIC CAP BEARING "KOSIE P.S. 8167" SET. SAID POINT BEING A SOUTHWESTERLY CORNER OF SAID MILLER'S LAND. SAID POINT ALSO BEING THE NORTHWESTERLY CORNER OF THE PARCEL HEREIN DESCRIBED.

THENCE S00°32'58"E ALONG THE WESTERLY LINE OF THE PARCEL HEREIN DESCRIBED AND PARALLEL WITH THE CENTERLINE OF SAID MUMFORD ROAD A DISTANCE OF 170.00 FEET TO A 5/8" (DIAMETER) x 30" (LONG) IRON PIN WITH YELLOW PLASTIC CAP BEARING "KOSIE P.S. 8167" SET ON A NORTHERLY LINE OF A PARCEL OF LAND CONVEYED TO J.M. SLEPKO AS RECORDED IN VOL. 571, PG. 532 OF GEAUGA COUNTY RECORDS AND DEEDS. SAID POINT BEING THE SOUTHWESTERLY CORNER OF THE PARCEL HEREIN DESCRIBED.

THENCE N88°58'05"E ALONG SAID SLEPKO'S NORTHERLY LINE AND PASSING THROUGH A 5/8" (DIAMETER) x 30" (LONG) IRON PIN WITH YELLOW PLASTIC CAP BEARING "KOSIE P.S. 8167" SET AT 339.00 FEET A TOTAL DISTANCE OF 369.00 FEET TO A POINT ON THE CENTERLINE OF THE AFORESAID MUMFORD ROAD. SAID POINT BEING A NORTHEASTERLY CORNER OF SAID SLEPKO'S LAND. SAID POINT ALSO BEING THE SOUTHEASTERLY CORNER OF THE PARCEL HEREIN DESCRIBED.

THENCE N00°32'58"W ALONG SAID CENTERLINE A **FRONTAGE DISTANCE** OF 170.00 FEET TO **THE PRINCIPAL PLACE OF BEGINNING OF THIS SURVEY** AND CONTAINING 1.4400 ACRES OF LAND AS SURVEYED BY DELMAR B. KOSIE AND ASSOCIATES (ROBERT L. KOSIE, REGISTERED PROFESSIONAL LAND SURVEYOR NO. 8167). BEARINGS ARE TO TRUE NORTH USING NAD83 (NGVD 29) APRIL, 2004. BE THE SAME, MORE OR LESS, BUT SUBJECT TO ALL LEGAL HIGHWAYS.

TRO 00091

Delmar B. Kosie & Associates



Registered Land Surveyors
202 South Street
Chardon, Ohio 44024-1321
(440) 286-2131
Fax: (440) 285-4579

<http://home.alltel.net/dbkads1/home.htm>

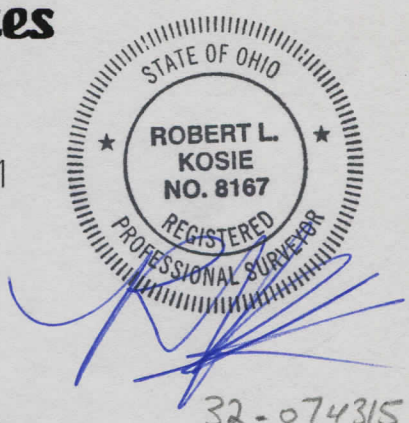

20.0030 GROSS ACRE PARCEL

DEED OF RECORD: H.M. AND S.R. MILLER VOLUME 619, PG. 727

32-074315
Vol. 1731-Pg. 1850

Date: APRIL 30TH, 2004

SITUATED IN THE TOWNSHIP OF TROY, COUNTY OF GEauga AND STATE OF OHIO AND KNOWN AS BEING PART OF ORIGINAL SECTION NO. 2 WITHIN SAID TOWNSHIP AND BOUNDED AND DESCRIBED AS FOLLOWS:

BEGINNING AT A 1" IRON PIN IN A MONUMENT BOX FOUND AT AN ANGLE POINT AT THE INTERSECTION OF PATCH ROAD (60 FEET WIDE) AND MUMFORD ROAD (60 FEET WIDE). SAID POINT BEING KNOWN AS CENTERLINE STATION 113+86.70 OF THE GEauga COUNTY ENGINEER'S RECORDS.

THENCE S88°47'42"W ALONG THE CENTERLINE OF PATCH ROAD A DISTANCE OF 230.00 FEET TO A POINT. SAID POINT BEING A NORTHWESTERLY CORNER OF A PARCEL OF LAND CONVEYED TO R. AND P. DOBAY AS RECORDED IN VOL. 550, PG. 746 OF GEauga COUNTY RECORDS AND DEEDS. SAID POINT ALSO BEING A NORTHEASTERLY CORNER OF THE PARCEL HEREIN DESCRIBED AND **THE PRINCIPAL PLACE OF BEGINNING OF THIS SURVEY.**

THENCE S03°05'50"E ALONG A WESTERLY LINE OF SAID DOBAY'S LAND AND PASSING THROUGH A 5/8" (DIAMETER) x 30" (LONG) IRON PIN WITH YELLOW PLASTIC CAP BEARING "KOSIE P.S. 8167" SET AT 30.00 FEET A TOTAL DISTANCE OF 150.00 FEET TO A 5/8" (DIAMETER) x 30" (LONG) IRON PIN WITH YELLOW PLASTIC CAP BEARING "KOSIE P.S. 8167" SET. SAID POINT BEING A SOUTHWESTERLY CORNER OF SAID DOBAY'S LAND.

THENCE N88°47'42"E ALONG A SOUTHERLY LINE OF SAID DOBAY'S LAND AND PASSING THROUGH A 5/8" (DIAMETER) x 30" (LONG) IRON PIN WITH YELLOW PLASTIC CAP BEARING "KOSIE P.S. 8167" SET AT 199.98 FEET A TOTAL DISTANCE OF 230.00 FEET TO A POINT ON THE CENTERLINE OF THE AFORESAID MUMFORD ROAD.

THENCE S03°05'50"E ALONG SAID CENTERLINE A **FRONTAGE DISTANCE** OF 108.75 FEET TO A POINT. SAID POINT BEING A NORTHEASTERLY CORNER OF A PARCEL OF LAND CONVEYED TO E.E. AND B.H. YODER AS RECORDED IN VOL. 1061, PG. 902 OF GEauga COUNTY RECORDS AND DEEDS. SAID POINT ALSO BEING A SOUTHEASTERLY CORNER OF THE PARCEL HEREIN DESCRIBED.

THENCE S86°28'38"W AND PASSING THROUGH A 5/8" IRON PIN WITH CAP BEARING "SLAY 5298" FOUND AT 28.04 FEET AND ALSO PASSING THROUGH A 5/8" (DIAMETER) x 30" (LONG) IRON PIN WITH YELLOW PLASTIC CAP BEARING "KOSIE P.S. 8167" SET 30.00 FEET A TOTAL DISTANCE OF 698.05 FEET TO A 5/8" IRON PIN FOUND BENT WITH DAMAGED CAP (CONED AND RE-STRAIGHTENED). SAID POINT BEING A NORTHWESTELY CORNER OF SAID YODER'S LAND.

THENCE S03°29'09"E ALONG A WESTERLY LINE OF SAID YODER'S LAND A DISTANCE OF 249.74 FEET TO A 5/8" (DIAMETER) x 30" (LONG) IRON PIN WITH YELLOW PLASTIC CAP BEARING "KOSIE P.S. 8167" SET. SAID POINT BEING A SOUTHWESTERLY CORNER OF SAID YODER'S LAND.

THENCE N86°28'38"E ALONG A SOUTHERLY LINE OF SAID YODER'S LAND AND PASSING THROUGH A 5/8" (DIAMETER) x 30" (LONG) IRON PIN WITH YELLOW PLASTIC CAP BEARING "KOSIE P.S. 8167" SET AT 666.36 FEET AND ALSO PASSING THROUGH A 5/8" IRON PIN WITH CAP BEARING "SLAY 5298" FOUND AT 670.01 FEET A TOTAL DISTANCE OF

TR0 00091

Delmar B. Kosie & Associates



Registered Land Surveyors
202 South Street
Chardon, Ohio 44024-1321
(440) 286-2131
Fax: (440) 285-4579

<http://home.alltel.net/dbkads1/home.htm>

20.0030 GROSS ACRE PARCEL

(CONTINUED)

SURVEY PLAT & LEGAL DESCRIPTION
APPROVED PER R.C. 315.251
R.S. 514104
OFFICE OF THE
GEAUGA COUNTY ENGINEER

696.36 FEET TO A POINT ON THE CENTERLINE OF THE AFORESAID MUMFORD ROAD. SAID POINT BEING A SOUTHEASTERLY CORNER OF SAID YODER'S LAND. SAID POINT ALSO BEING A NORTHEASTERLY CORNER OF THE PARCEL HEREIN DESCRIBED.

THENCE S03°05'50"E ALONG SAID CENTERLINE A **FRONTAGE DISTANCE** OF 217.21 FEET TO AN ANGLE POINT THEREIN. SAID POINT BEING KNOWN AS CENTERLINE STATION 106+61.00 OF THE GEAUGA COUNTY ENGINEER'S RECORDS.

THENCE S00°32'58"E CONTINUING ALONG SAID CENTERLINE A **FRONTAGE DISTANCE** OF 126.16 FEET TO A POINT. SAID POINT BEING A NORTHEASTERLY CORNER OF A PARCEL OF LAND CONVEYED TO S.A. AND A. MILLER AS RECORDED IN VOL. 597, PG. 227 OF GEAUGA COUNTY RECORDS AND DEEDS. SAID POINT ALSO BEING A SOUTHEASTERLY CORNER OF THE PARCEL HEREIN DESCRIBED.

THENCE S88°58'05"W ALONG A NORTHERLY LINE OF SAID MILLER'S LAND AND PASSING THROUGH A 5/8" (DIAMETER) x 30" (LONG) IRON PIN WITH YELLOW PLASTIC CAP BEARING "KOSIE P.S. 8167" SET AT 30.00 FEET A TOTAL DISTANCE OF 369.00 FEET TO A 5/8" (DIAMETER) x 30" (LONG) IRON PIN WITH YELLOW PLASTIC CAP BEARING "KOSIE P.S. 8167" SET. SAID POINT BEING A NORTHWESTERLY CORNER OF SAID MILLER'S LAND.

THENCE S00°32'58"E ALONG A WESTERLY LINE OF SAID MILLER'S LAND AND PARALLEL WITH THE CENTERLINE OF SAID MUMFORD ROAD AND PASSING THROUGH A 5/8" (DIAMETER) x 30" (LONG) IRON PIN WITH YELLOW PLASTIC CAP BEARING "KOSIE P.S. 8167" SET AT 125.00 FEET A TOTAL DISTANCE OF 295.00 FEET TO A 5/8" (DIAMETER) x 30" (LONG) IRON PIN WITH YELLOW PLASTIC CAP BEARING "KOSIE P.S. 8167" SET ON A NORTHERLY LINE OF A PARCEL OF LAND CONVEYED TO J.M. SLEPKO AS RECORDED IN VOL. 571, PG. 532 OF GEAUGA COUNTY RECORDS AND DEEDS. SAID POINT BEING A SOUTHEASTERLY CORNER OF THE PARCEL HEREIN DESCRIBED.

THENCE S88°58'05"W ALONG SAID SLEPKO'S NORTHERLY LINE AND ALSO ALONG A NORTHERLY LINE OF A PARCEL OF LAND CONVEYED TO J.M. SLEPKO, TRUSTEE AS RECORDED IN VOL. 968, PG. 466 OF GEAUGA COUNTY RECORDS AND DEEDS A DISTANCE OF 673.02 FEET TO A 5/8" (DIAMETER) x 30" (LONG) IRON PIN WITH YELLOW PLASTIC CAP BEARING "KOSIE P.S. 8167" SET. SAID POINT BEING THE SOUTHWESTERLY CORNER OF THE PARCEL HEREIN DESCRIBED.

THENCE N01°12'18"W ALONG THE WESTERLY LINE OF THE PARCEL HEREIN DESCRIBED AND PASSING THROUGH A 5/8" (DIAMETER) x 30" (LONG) IRON PIN WITH YELLOW PLASTIC CAP BEARING "KOSIE P.S. 8167" SET AT 1113.28 FEET A TOTAL DISTANCE OF 1143.28 FEET TO A POINT ON THE CENTERLINE OF THE AFORESAID PATCH ROAD. SAID POINT BEING THE NORTHWESTERLY CORNER OF THE PARCEL HEREIN DESCRIBED.

THENCE N88°47'42"E ALONG SAID CENTERLINE A **FRONTAGE DISTANCE** OF 792.87 FEET TO **THE PRINCIPAL PLACE OF BEGINNING OF THIS SURVEY** AND CONTAINING 20.0030 ACRES OF LAND AS SURVEYED BY DELMAR B. KOSIE AND ASSOCIATES (ROBERT L. KOSIE, REGISTERED PROFESSIONAL LAND SURVEYOR NO. 8167). BEARINGS ARE TO TRUE NORTH USING NAD83 (NGVD 29) APRIL, 2004. BE THE SAME, MORE OR LESS, BUT SUBJECT TO ALL LEGAL HIGHWAYS.

Delmar B. Kosie & Associates



Registered Land Surveyors
202 South Street
Chardon, Ohio 44024-1321
(440) 286-2131
Fax: (440) 285-4579

<http://home.alltel.net/dbkads1/home.htm>

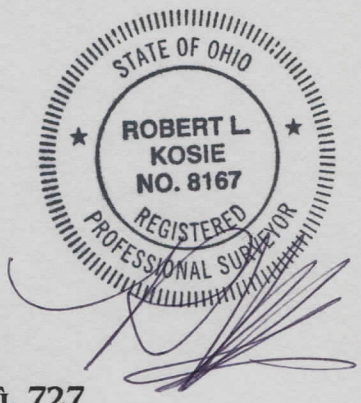

25.2683 GROSS ACRE PARCEL

DEED OF RECORD: H.M. AND S.R. MILLER VOLUME 619, PG. 727

Date: APRIL 30TH, 2004

SITUATED IN THE TOWNSHIP OF TROY, COUNTY OF GEauga AND STATE OF OHIO AND KNOWN AS BEING PART OF ORIGINAL SECTION NO. 2 WITHIN SAID TOWNSHIP AND BOUNDED AND DESCRIBED AS FOLLOWS:

BEGINNING AT A 1" IRON PIN IN A MONUMENT BOX FOUND AT AN ANGLE POINT AT THE INTERSECTION OF PATCH ROAD (60 FEET WIDE) AND MUMFORD ROAD (60 FEET WIDE). SAID POINT BEING KNOWN AS CENTERLINE STATION 113+86.70 OF THE GEauga COUNTY ENGINEER'S RECORDS.

THENCE S88°47'42"W ALONG THE CENTERLINE OF PATCH ROAD A DISTANCE OF 1022.87 FEET TO A POINT. SAID POINT BEING A NORTHEASTERLY CORNER OF THE PARCEL HEREIN DESCRIBED AND **THE PRINCIPAL PLACE OF BEGINNING OF THIS SURVEY.**

THENCE S01°12'18"E ALONG THE EASTERLY LINE OF THE PARCEL HEREIN DESCRIBED AND PASSING THROUGH A 5/8" (DIAMETER) x 30" (LONG) IRON PIN WITH YELLOW PLASTIC CAP BEARING "KOSIE P.S. 8167" SET AT 30.00 FEET A TOTAL DISTANCE OF 1143.28 FEET TO A 5/8" (DIAMETER) x 30" (LONG) IRON PIN WITH YELLOW PLASTIC CAP BEARING "KOSIE P.S. 8167" SET ON A NORTHERLY LINE OF A PARCEL OF LAND CONVEYED TO J.M. SLEPKO, TRUSTEE AS RECORDED IN VOL. 968, PG. 466 OF GEauga COUNTY RECORDS AND DEEDS. SAID POINT BEING THE SOUTHEASTERLY CORNER OF THE PARCEL HEREIN DESCRIBED.

THENCE S88°58'05"W ALONG SAID SLEPKO'S NORTHERLY LINE A DISTANCE OF 1060.46 FEET TO A 5/8" (DIAMETER) x 30" (LONG) IRON PIN WITH YELLOW PLASTIC CAP BEARING "KOSIE P.S. 8167" SET. SAID POINT BEING A SOUTHEASTERLY CORNER OF A PARCEL OF LAND CONVEYED TO M.H. AND R.C. WEAVER AS RECORDED IN VOL. 1719, PG. 566 OF GEauga COUNTY RECORDS AND DEEDS. SAID POINT ALSO BEING THE SOUTHWESTERLY CORNER OF THE PARCEL HEREIN DESCRIBED.

THENCE N01°04'37"W ALONG AN EASTERLY LINE OF SAID WEAVER'S LAND AND PASSING THROUGH A 5/8" (DIAMETER) x 30" (LONG) IRON PIN WITH YELLOW PLASTIC CAP BEARING "KOSIE P.S. 8167" SET AT 1110.08 FEET A TOTAL DISTANCE OF 1140.08 FEET TO A POINT ON THE CENTERLINE OF THE AFORESAID PATCH ROAD. SAID POINT BEING A NORTHEASTERLY CORNER OF SAID WEAVER'S LAND. SAID POINT ALSO BEING A NORTHWESTERLY CORNER OF THE PARCEL HEREIN DESCRIBED.

TR000091

Delmar B. Kosie & Associates



Registered Land Surveyors
202 South Street
Chardon, Ohio 44024-1321
(440) 286-2131
Fax: (440) 285-4579

<http://home.alltel.net/dbkads1/home.htm>

25.2683 GROSS ACRE PARCEL

(CONTINUED)

THENCE N88°47'42"E ALONG SAID CENTERLINE A **FRONTAGE DISTANCE** OF 102.78 FEET TO A POINT. SAID POINT BEING A NORTHWESTERLY CORNER OF A PARCEL OF LAND CONVEYED TO D.J. AND R.S. YODER AS RECORDED IN VOL. 576, PG. 215 OF GEAUGA COUNTY RECORDS AND DEEDS. SAID POINT ALSO BEING A NORTHEASTERLY CORNER OF THE PARCEL HEREIN DESCRIBED.

THENCE S01°04'37"E ALONG A WESTERLY LINE OF SAID YODER'S LAND AND PASSING THROUGH A 5/8" (DIAMETER) x 30" (LONG) IRON PIN WITH YELLOW PLASTIC CAP BEARING "KOSIE P.S. 8167" SET AT 30.00 FEET A TOTAL DISTANCE OF 331.00 FEET TO A 5/8" (DIAMETER) x 30" (LONG) IRON PIN WITH YELLOW PLASTIC CAP BEARING "KOSIE P.S. 8167" SET. SAID POINT BEING A SOUTHWESTERLY CORNER OF SAID YODER'S LAND.

THENCE N88°47'42"E ALONG A SOUTHERLY LINE OF SAID YODER'S LAND AND PARALLEL WITH THE CENTERLINE OF PATCH ROAD A DISTANCE OF 328.00 FEET TO A 5/8" (DIAMETER) x 30" (LONG) IRON PIN WITH YELLOW PLASTIC CAP BEARING "KOSIE P.S. 8167" SET. SAID POINT BEING A SOUTHEASTERLY CORNER OF SAID YODER'S LAND.

THENCE N01°04'37"W ALONG AN EASTERLY LINE OF SAID YODER'S LAND AND PASSING THROUGH A 5/8" (DIAMETER) x 30" (LONG) IRON PIN WITH YELLOW PLASTIC CAP BEARING "KOSIE P.S. 8167" SET AT 301.00 FEET A TOTAL DISTANCE OF 331.00 FEET TO A POINT ON THE CENTERLINE OF THE AFORESAID PATCH ROAD. SAID POINT BEING A NORTHEASTERLY CORNER OF SAID YODER'S LAND. SAID POINT ALSO BEING A NORTHWESTERLY CORNER OF THE PARCEL HEREIN DESCRIBED.

THENCE N88°47'42"E ALONG SAID CENTERLINE A **FRONTAGE DISTANCE** OF 627.13 FEET TO **THE PRINCIPAL PLACE OF BEGINNING OF THIS SURVEY** AND CONTAINING 25.2683 ACRES OF LAND AS SURVEYED BY DELMAR B. KOSIE AND ASSOCIATES (ROBERT L. KOSIE, REGISTERED PROFESSIONAL LAND SURVEYOR NO. 8167). BEARINGS ARE TO TRUE NORTH USING NAD83 (NGVD 29) APRIL, 2004. BE THE SAME, MORE OR LESS, BUT SUBJECT TO ALL LEGAL HIGHWAYS.

SURVEY PLAT & LEGAL DESCRIPTION
APPROVED PER R.C. 315.251

R.S. 5/4/04
OFFICE OF THE
GEAUGA COUNTY ENGINEER